



ARCHITECTURAL COMMITTEE  
APPLICATION FOR EXTERIOR IMPROVEMENTS/CHANGES

*Continued -- For office use only*

NEIGHBORHOOD: Wentworth

LOT #: 26

HOMEOWNER: Walter & Susan Hughes

ADDRESS: 7357 Windemere Lane

SUBMITTAL SUBJECT: reroof home: Boral Saxony 900 slate Café Sand Blend

---

AC COMMENTS:

Dear Walter & Susan Hughes:

Your recent submittal to the Architectural Committee was reviewed on 5/22/2020. The application is **Approved as Submitted** with the following stipulations:

**None**

AC Submissions to be delivered to:  
The Architectural Committee

8301 The Park Boulevard  
University Park, FL 34201  
Or by email to [ac@upcai-fl.com](mailto:ac@upcai-fl.com)

<p><b>For Official Use Only</b></p> <p>UPCAI Architectural Committee</p> <p>Submission reviewed 5/22/2020 [Signature]</p> <p>on _____</p> <p><b>APPROVED</b></p>
--



**ARCHITECTURAL COMMITTEE  
APPLICATION FOR EXTERIOR IMPROVEMENTS/CHANGES  
SINGLE FAMILY HOMES**

In accordance with the Declaration of Covenants, Conditions and Restrictions for University Park, I hereby submit this request for consideration:

DATE: MAY 1, 2020 REVIEW FEE: \$ 2500  
 NEIGHBORHOOD: WENTWORTH LOT # 26  
 HOMEOWNER: WALTER + SUSAN HUGHES HOME BUILDER: \_\_\_\_\_  
 ADDRESS: 7357 WINDEMERE LN. U.P.  
 PHONE #: (411) 3590060 E-MAIL: WJHUP1@GMAIL.COM

Every submission **MUST** include the following: **3 PHOTOS** taken from different angles showing existing areas where the work is proposed. These can be submitted as hard copies or emailed to [ac@upcai-fl.com](mailto:ac@upcai-fl.com). **REVIEW FEE** (see below for details). For landscape changes a **PLAN** or **SKETCH** of the proposed work is required. For **REPAINTING** a **full height sample** of the body color must be applied to the front of the home together with trim colors and be visible from the street. Brochures or sample materials will facilitate approval. **All Applicants should review the AC CRITERIA sheets on the website [www.upcai-fl.com](http://www.upcai-fl.com)**

Requested Work: ROOF REPLACEMENT

**Schedule of Fees – January 1, 2018**

Each application must include a check in the amount of the appropriate fee, made payable to UPCAI. If you are unsure as to the applicable amount, please contact the Committee at [ac@upcai-fl.com](mailto:ac@upcai-fl.com) for information. The following schedule of review fees is issued as a guide. Each submittal is reviewed and assessed independently (*additional fees may apply*). The review fee is subject to change and the schedule updated.

New Home Submittals ( <i>fee dependent on neighborhood</i> )	\$750.00 - \$1,200.00
Application to Rebuild a Home in Entirety or Substantially ( <i>fee dependent on neighborhood</i> )	\$750.00 - \$1,200.00
Application for Major Remodeling or Home Extensions ( <i>2<sup>nd</sup> story bonus rooms or adding rooms</i> )	\$300.00-\$500.00
Application for Structural Additions ( <i>extending garages, adding pool and deck changes</i> )	\$150.00

Application to install following items: Satellite/Antenna/Dish, Invisible Dog Fence, Coach Lights, Geothermal or Heat Pump Installation; External Generator; Hurricane Shutters; Solar Panels for pool or home, Solar Film to Windows; Repaint House and/or Accent Colors (*doors, shutters, etc*); Screen, Enclose or Extend Lanai; Hardscape Additions (*fountains, statuary, landscape lighting, dog runs, etc.*); Changes to

Landscape Plan or Lake Bank Retaining Walls or Stabilizing Treatment and all other applications \$25.00



From: Susan Hughes suehus3@gmail.com

Subject: House

Date: May 3, 2020 at 12:49:57 PM

To: Walter Hughes WJHUP1@gmail.com

---

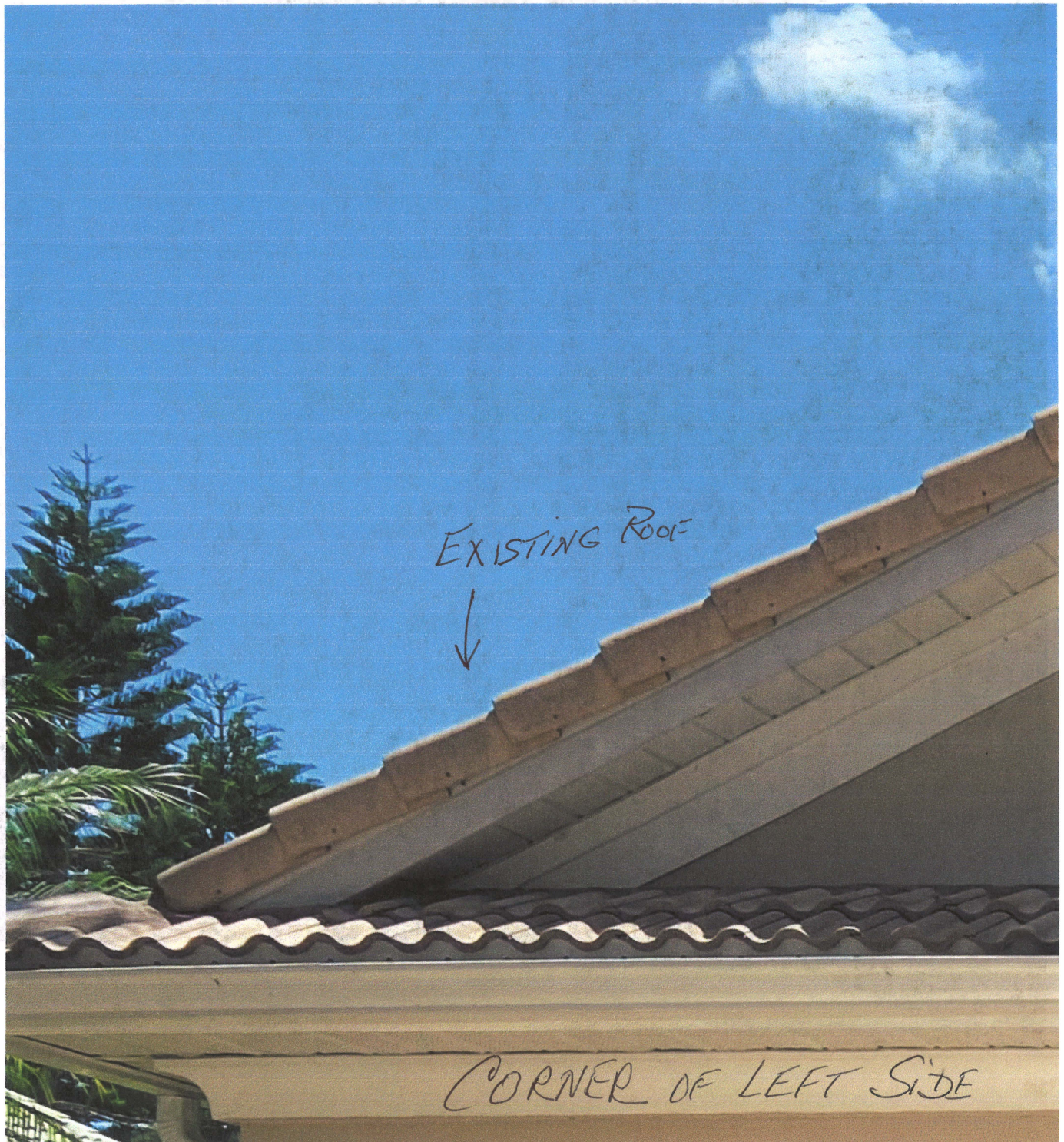



EXISTING





OLD ROOF TILES

7357 WINDEMERE LN. (WENTWORTH)



OLD ROOF TILES

7357 WINDEMERE LN. (WENTWORTH)







Sent from my iPhone

EXISTING  
DRIVEWAY





GARAGE DOOR

SLATE 900  
CAFE' SAND BLEND c/t

→ REPLACEMENT  
TILE -

BORAL, MFG.

DRIVEWAY















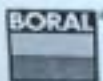

BORAL®

**BORAL**

Roof Tile and Components

**1FMCS3360**

Slate 900 Café Sand Blend C/T